

# **Plans and drawings relevant to reports submitted to Eastern Area Planning Committee**

**Wednesday 23<sup>rd</sup> November 2022 at 6.30pm**

**At Council Chamber, Council Offices, Market Street,  
Newbury, RG14 5LD**

**&**

**And via Zoom**

**[to be read in conjunction with the main agenda]**

*Please note:*

- *All drawings are copied at A4 and consequently are not scalable*
- *Most relevant plans have been included – however, in some cases, it may be necessary for the case officer to make a selection*
- *All drawings are available to view at [www.westberks.gov.uk](http://www.westberks.gov.uk)*



**WestBerkshire**  
C O U N C I L

21/01097/COMIND  
Land at New Barn Farm  
Wantage Road  
Lambourn

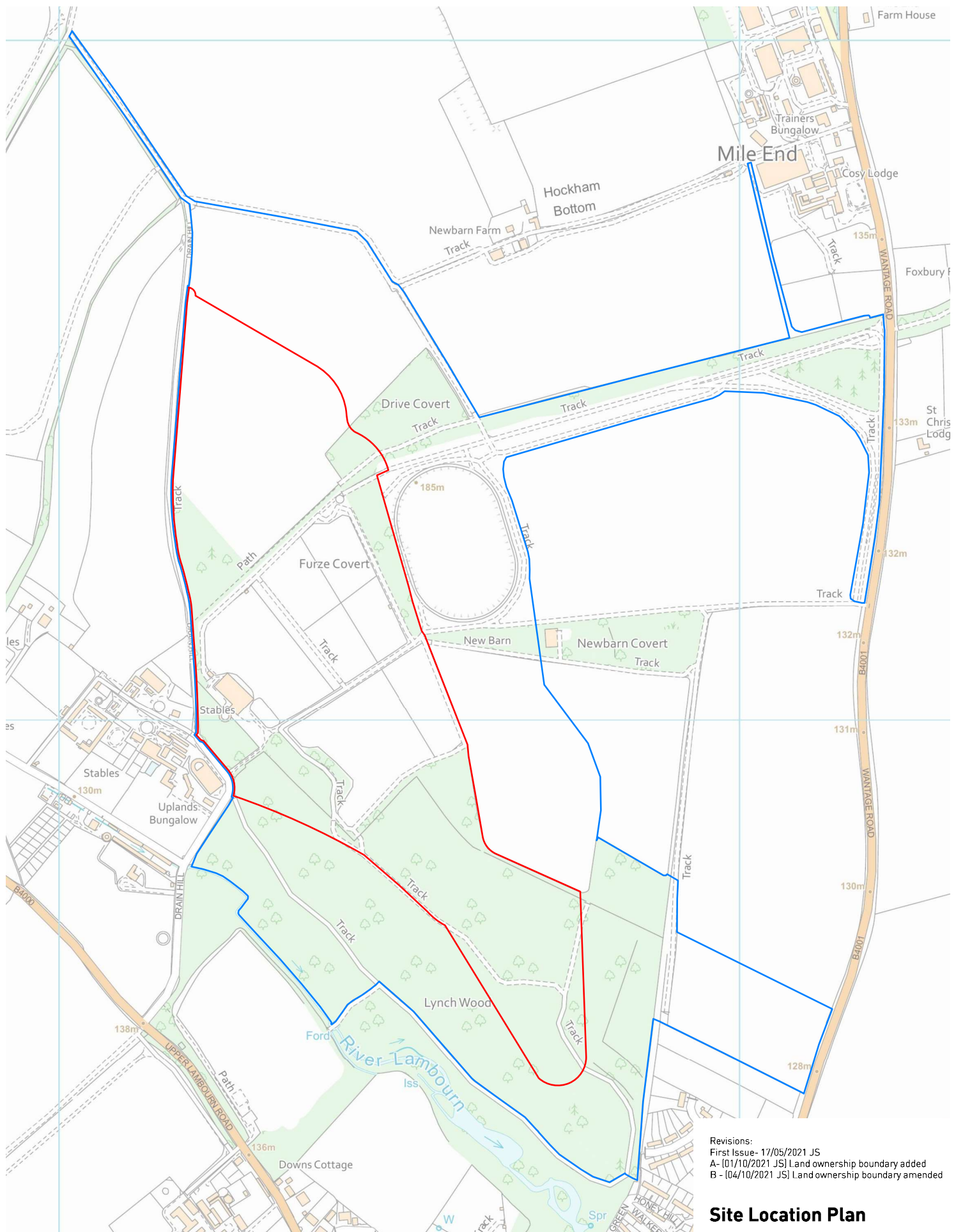

Revisions:  
 First Issue- 17/05/2021 JS  
 A- [01/10/2021 JS] Land ownership boundary added  
 B - [04/10/2021 JS] Land ownership boundary amended

## Site Location Plan New Barn Farm, Lambourn

Client: Jamie Osbourne  
 DRWG No: **P21-0131\_07**  
 Drawn by: JS  
 Date: 04/10/2021  
 Scale: 1:5,000 @ A3

Sheet No: **1** REV: **B**  
 Approved by: AJ  
**Pegasus**  
 Environment

### KEY

- Site Boundary
- Land in Same Ownership



DESIGN | ENVIRONMENT | PLANNING | ECONOMICS | HERITAGE

Copyright Pegasus Planning Group Ltd. © Crown copyright and database rights 2020 Ordnance Survey 100031673. Emap's licence number 0100031673. Promap's licence number 10020449.  
 Pegasus accepts no liability for any use of this document other than for its original purpose, or by the original client, or following Pegasus' express agreement to such use. T 01295641717 www.pegasusgroup.co.uk



- KEY**
- SITE BOUNDARY
  - GALLOP
  - MAINTENANCE TRACK
  - EXISTING WOODLAND
  - PROPOSED NATIVE WOODLAND
  - PROPOSED NATIVE HEDGE
  - PROPOSED GRAZING GRASS
  - PROPOSED SCRUB PLANTING
  - INDICATIVE LOCATION FOR BEE BANKS / HIBERNACULA
  - POND
  - WETLAND AREA
  - PUBLIC RIGHT OF WAY LAMB/26/1
  - CHALK REMEDIATED ARABLE LAND

**Site Plan**  
**New Barn Farm Lambourn**

Client: Jamie Osborne  
DRWG No: P20-0131\_01 Sheet No: REV:  
Drawn by: ARW Approved by: IW  
Date: 25/03/2021  
Scale: 1:1500 @ A1



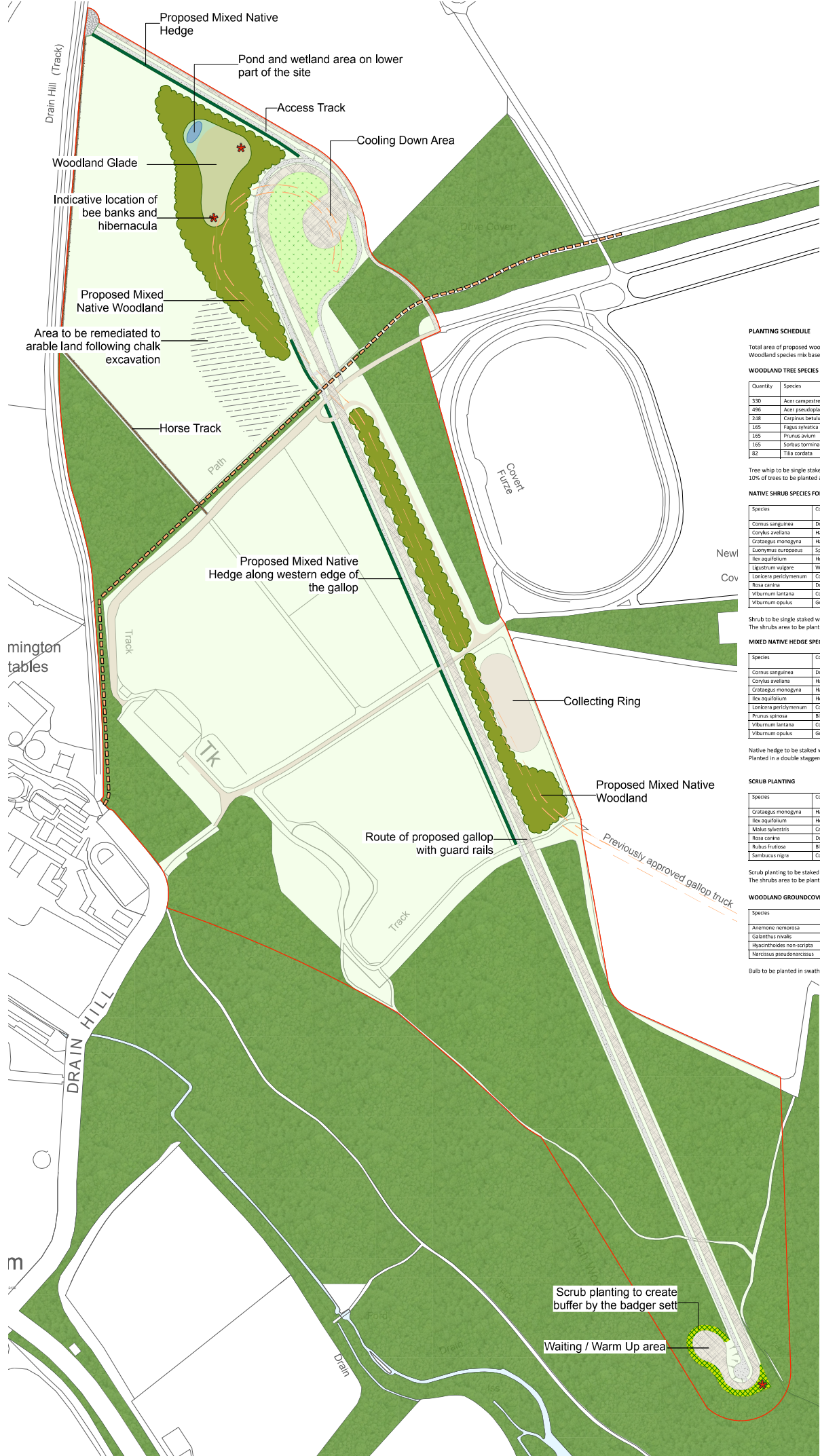

KEY

SITE BOUNDARY

GALLOP

MAINTENANCE TRACK

EXISTING WOODLAND

PROPOSED NATIVE WOODLAND

PROPOSED NATIVE HEDGE

PROPOSED GRAZING GRASS

PROPOSED SCRUB PLANTING

INDICATIVE LOCATION FOR BEE BANKS / HIBERNACULA

POND

WETLAND AREA

PUBLIC RIGHT OF WAY LAMB/26/1

**PLANTING SCHEDULE**

Total area of proposed woodland 149.16 m2

Woodland species mix based on approximated species and percentages felled (excluding Ash due to Ash die back)

Quantity	Species	Common name	Height (cm)	specification	%
330	Acer campestre	Field maple	80-100	Whip	20
496	Acer pseudoplatanus	Sycamore	80-100	Whip	30
248	Carpinus betulus	Hornbeam	80-100	Whip	15
165	Fagus sylvatica	Beech	80-100	Whip	10
165	Prunus avium	Wild cherry	80-100	Whip	10
165	Sorbus torminalis	Wild service tree	80-100	Whip	10
82	Tilia cordata	Small-leaved Lime	80-100	Whip	5

Tree whip to be single staked and mesh guarded on a grid with 3m centres

10% of trees to be planted as standards (Girth 8-10cm)

Species	Common name	Height (cm)	specification	%
Cornus sanguinea	Dogwood	60-80	Transplant	7.5
Cornus avellana	Hazel	60-80	Transplant	27.5
Crataegus monogyna	Hawthorn	60-80	Transplant	27.5
Eucryphia europaea	Spindle	60-80	Transplant	5
Ilex aquifolium	Holly	45	Pot-grown	5
Ligustrum vulgare	Wild privet	60-80	Transplant	10
Lonicera periclymenum	Common honeysuckle	45	Pot-grown	5
Rosa canina	Dog rose	60-80	Transplant	2.5
Viburnum lantana	Common wayfaring tree	60-80	Transplant	5
Viburnum opulus	Guelder rose	60-80	Transplant	5

Shrub to be single staked with bamboo and guarded using spiral guards.

The shrubs area to be planted on a grid at 2m centres between the shrubs.

Species	Common name	Height (cm)	specification	%
Cornus sanguinea	Dogwood	60-90	Bare Root Whip	10
Cornus avellana	Hazel	60-90	Bare Root Whip	35
Crataegus monogyna	Hawthorn	60-90	Bare Root Whip	50
Ilex aquifolium	Holly	45	Pot-grown	5
Lonicera periclymenum	Common honeysuckle	60-90	Bare Root Whip	5
Prunus spinosa	Blackthorn	60-90	Bare Root Whip	5
Viburnum lantana	Common wayfaring tree	60-90	Bare Root Whip	5
Viburnum opulus	Guelder rose	60-90	Bare Root Whip	5

Native hedge to be staked with bamboo and guarded using spiral guards.

Planted in a double staggered row with 45cm centres.

Species	Common name	Height (cm)	specification	%
Crataegus monogyna	Hawthorn	60-90	Bare Root Whip	15
Ilex aquifolium	Holly	45	Pot-grown	5
Malus sylvestris	Crap Apple	80-100	Bare Root Whip	10
Rosa canina	Dog rose	60-80	Bare Root Whip	10
Rubus fruticosus	Blackberry	40-60	Bare Root	10
Sambucus nigra	Common Elder	60-80	Bare Root Whip	10

Scrub planting to be staked with bamboo and guarded using spiral guards.

The shrubs area to be planted on a grid at 1.2m centres between the shrubs.

Species	Common name	specification	%
Anemone nemorosa	Wood anemone	Bulb	25
Galanthus nivalis	Common snowdrop	Bulb	25
Hyacinthoides non-scripta	Bluebell	Bulb	25
Narcissus pseudonarcissus	Wild daffodil	Bulb	25

Bulb to be planted in swathes on grid with 10cm centres within the woodland grass mix.

**Woodland Areas**

The recommended woodland wildflower and grass mix for the scheme is: Emorgate EM1 - Hedgerow Mixture

This mix is to be sown at a rate of 4g/m2

Grass mixture to be supplemented with Viola odorata (Sweet violet) and Allium ursinum (Ranunculus)

**Woodland Glade**

The recommended woodland glade mix for the scheme is: Emorgate EM10 - Meadow mixture for Wetlands.

This mix is to be sown at rate of 4g/m2

**Wetland Area**

The recommended woodland glade mix for the scheme is: Emorgate EM4 - Tussock Mixture

This mix is to be sown at rate of 4g/m2

**Waiting and Cooling Down Areas**

The recommended grass mix for this area is: Emorgate EG27 - Special Old Fashioned Grazing Mixture.

This mix is to be sown at a rate 4g/m2

